

For use with EpiPen® adrenaline autoinjectors

Name: \_\_\_\_\_

Date of birth: \_\_\_\_\_

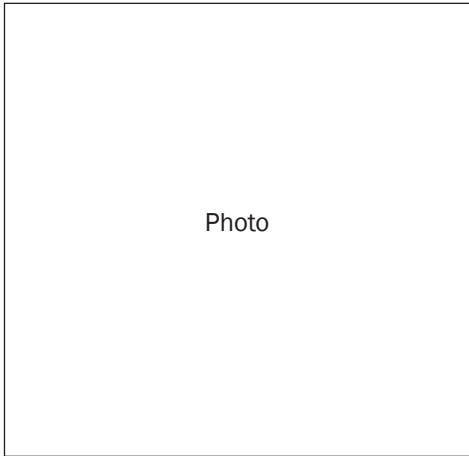

Photo

Confirmed allergens:

Family/emergency contact name(s):

Work Ph: \_\_\_\_\_

Home Ph: \_\_\_\_\_

Mobile Ph: \_\_\_\_\_

Plan prepared by:

Dr: \_\_\_\_\_

I hereby authorise medications specified on this plan to be administered according to the plan.

Signed:

Date: \_\_\_\_\_

Date of next review: \_\_\_\_\_

## How to give EpiPen®

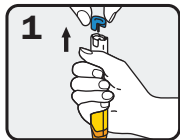

Form fist around EpiPen® and PULL OFF BLUE SAFETY RELEASE.

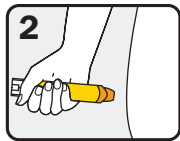

PLACE ORANGE END against outer mid-thigh (with or without clothing).

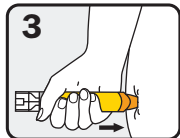

PUSH DOWN HARD until a click is heard or felt and hold in place for 10 seconds.

REMOVE EpiPen®. Massage injection site for 10 seconds.

Instructions are also on the device label and at: [www.allergy.org.au/anaphylaxis](http://www.allergy.org.au/anaphylaxis)

## MILD TO MODERATE ALLERGIC REACTION

- Swelling of lips, face, eyes
- Hives or welts
- Tingling mouth
- Abdominal pain, vomiting (these are signs of anaphylaxis for insect allergy)

## ACTION FOR MILD TO MODERATE ALLERGIC REACTION

- For insect allergy, flick out sting if visible. Do not remove ticks.
- Stay with person and call for help.
- Locate EpiPen® or EpiPen® Jr adrenaline autoinjector.
- Give other medications (if prescribed).....
- Phone family/emergency contact.

**Mild to moderate allergic reactions may not always occur before anaphylaxis**

Watch for **ANY ONE** of the following signs of anaphylaxis

## ANAPHYLAXIS (SEVERE ALLERGIC REACTION)

- Difficult/noisy breathing
- Swelling of tongue
- Swelling/tightness in throat
- Difficulty talking and/or hoarse voice
- Wheeze or persistent cough
- Persistent dizziness or collapse
- Pale and floppy (young children)

## ACTION FOR ANAPHYLAXIS

- 1 Lay person flat. Do not allow them to stand or walk. If breathing is difficult allow them to sit.**
- 2 Give EpiPen® or EpiPen® Jr adrenaline autoinjector.**
- 3 Phone ambulance\*: 000 (AU) or 111 (NZ).**
- 4 Phone family/emergency contact.**
- 5 Further adrenaline doses may be given if no response after 5 minutes, if another adrenaline autoinjector is available.**

**If in doubt, give adrenaline autoinjector**

**Commence CPR at any time if person is unresponsive and not breathing normally.**

EpiPen® is generally prescribed for adults and children over 5 years.

EpiPen® Jr is generally prescribed for children aged 1-5 years.

\*Medical observation in hospital for at least 4 hours is recommended after anaphylaxis.

## IF UNCERTAIN WHETHER IT IS ANAPHYLAXIS OR ASTHMA

- Give adrenaline autoinjector FIRST, then asthma reliever.
- If someone with known food or insect allergy suddenly develops severe asthma like symptoms, give adrenaline autoinjector FIRST, then asthma reliever.

Asthma: Y  N  Medication: \_\_\_\_\_